

Personnel Lifting Hoists - Electric - Pneumatic - Hydraulic - Wireless Controlled



The New Standard in Personnel Lifting

Historically, personnel lifting has been accomplished using a material lifting winch, or a winch that has been modified to lift personnel. Unfortunately, many accidents have occurred while using this equipment. These injuries have been attributed to two major factors:

- Ascent and descent rates have been too fast, ie. 90 to 120 fpm
- Miscommunication between the winch operator and rider

To solve these problems, Bishop Lifting Products Inc. offers a design which incorporates a proven slower and smoother operating personnel hoist, specialized mast, and wireless remote control that the rider controls.

Wireless Remote Controls

The concept of utilizing a wireless handheld remote control is what separates the MaxiRider™ from previous types of personnel lifting. The wireless remote was incorporated to eliminate communication errors between the winch operator and the rider. By simply removing the winch operator from the equation, the chance of injury is greatly reduced.

The handheld remote is easy to use, easy to understand, and low maintenance. It is constructed of impact resistant plastic, fitted inside a clear sleeve which is connected to a lanyard that prevents a potential dropped object hazard.

Each unit can be supplied with a back up handheld remote control and battery case. The backup handheld remote should be kept in the drillers shack until needed. Backup batteries should be readily accessible as well.

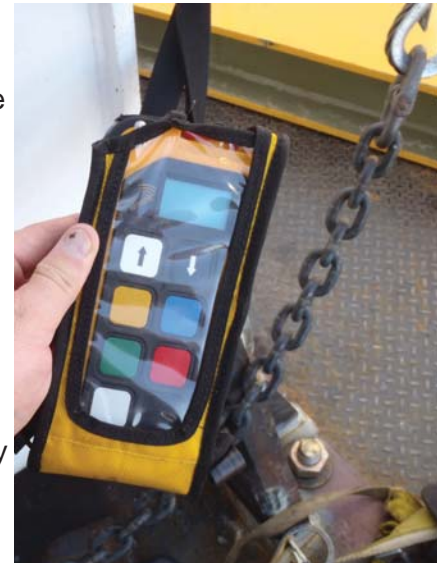

Features	Winch	MaxiRider™	MaxiRider™ Advantages
Handheld Wireless Controls	No	Yes	Rider has complete control; not limited to relying on hand signals, relay persons, or radio communications.
Over Speed Brake	No	Yes	Automatic brake engages if hoist line surges suddenly.
Upper Limit Switch	No	Yes	The rider cannot be two blocked at the crown.
Emergency Decent	No	Yes	In case of an emergency and rider is unable to operate controls, this feature enables them to be lowered to the floor at a controlled rate.
Centrifugal Brake	Optional	Yes	Internal secondary brake
Smooth & Precise Travel	No	Yes	35 fpm, smooth, precise, and controlled travel
Fewer Personnel Required	No	Yes	No need for winch operator, signal person, or others.
Emergency Stop	No	Yes	Rider can immediately stop by releasing the up or down button, or by depressing the red emergency stop button.
Instantaneous Controls	No	Yes	When control buttons are depressed, immediate hoist travel occurs. When buttons are released, hoist travel stops immediately.
Level Wind	Optional	Yes	Mechanical hands free level wind is standard.
Portability	No	Yes	Hoist can be removed quickly for easy transport.
Compact Size	No	Yes	Small footprint enables the unit to be located out of the way of rotating equipment.
Impact Protection	No	Yes	Equipped with exoskeleton type cage that protects unit against impacts.

MaxiRider™ I

Features:

- Hoist fully controlled by rider
- Installed on top of crown or floor
- Protective cage
- Vinyl tarp over cage to help eliminate moisture in the unit
- Smooth and easy acceleration and deceleration
- Upper limit switch
- Handheld remote in belted pouch to prevent dropping
- “Bloc-Stop” senses over speed and locks secondary brakes
- Manual break release allows rider to be lowered if there is power failure on rig
- Wireless handheld controls Class I, Div. II



MaxiRider™ II

Features:

- Hoist fully controlled by rider
- Easily installed anywhere on the drill floor or on the crown
- Protective cage
- Vinyl tarp over cage to help eliminate moisture in the unit
- Requires McKissick M-491 man rated block(s)
- Smooth and easy acceleration and deceleration
- Upper and lower limit switches
- Handheld remote in belted pouch to prevent dropping
- “Bloc-Stop” senses over speed and locks secondary brakes
- Secondary controls at hoist for emergency operation in case of remote failure
- Manual break release allows rider to be lowered if there is power failure on rig
- Entire unit and wireless handheld controls Class I, Div. II



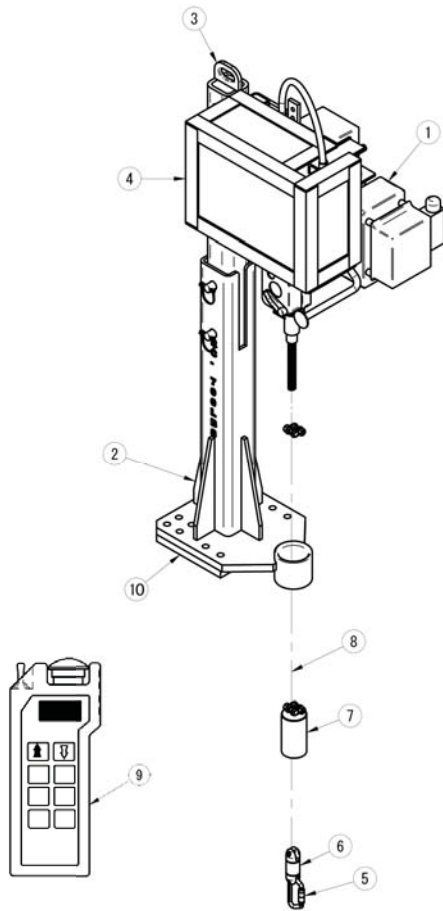

MaxiRider™ I

Part# MR1-CMS-NIS
Hoist: Tractel Tirak®
XE 301 P

Rated Capacity: 700 lbs.
Wire Rope Diameter:
5/16" (8mm)
Reach: 210' std., custom
available
Speed: 35 fpm
Location: Crown mounted
Power: Electric
Voltage: 110v / 1 Phase
Amps: 12
Weight: 395 lbs.

1. Electrical Motor and Hoist
2. Stand; Base
3. Stand; Head Support
4. Protective Cage
5. Carabiner
6. Angular Contact Swivel
7. Counterweight 15 lbs.
8. Wire Rope Assembly
9. Class I, Div. II Wireless Remote Control
10. Base

* Blocstop® included but not shown in this drawing perspective
* Yellow vinyl tarp included but not shown

Special models:

UltraRider™ - Air Operated with 110v control voltage, available in either crown or floor mount, specify which mounting system is needed.

HydraRider™ - Hydraulic Unit with 110v control voltage, requires well defined information prior to quoting and has extended delivery.

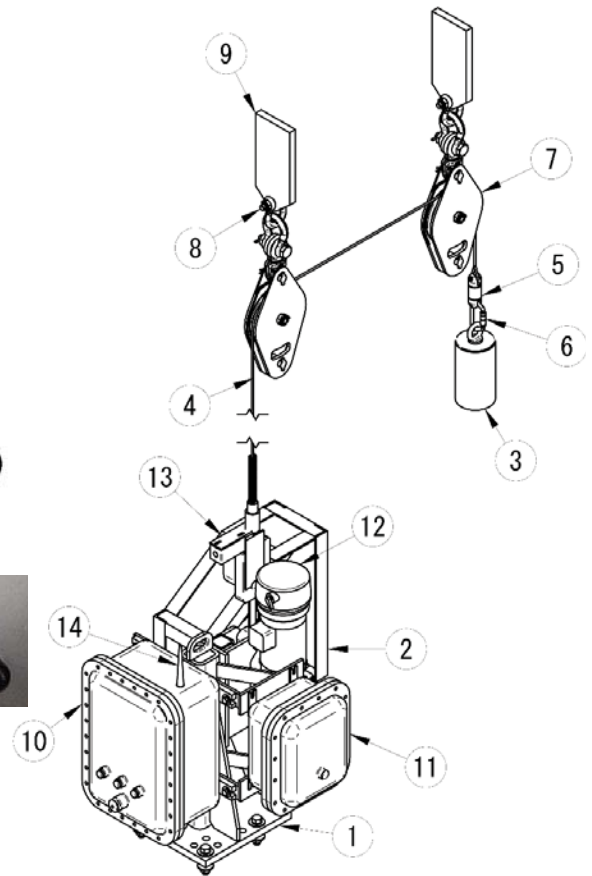

MaxiRider™ II

Part# MR2-FMB-IS
Hoist: Tractel Tirak®
XE 301 P

Rated Capacity: 700 lbs.
Wire Rope Diameter:
5/16" (8mm)
Wire Rope Length:
400' std., custom
available
Speed: 35 fpm
Location: Drill floor std.
Power: Electric
Voltage: 220v / 3 Phase
Amps: 5
Weight: 680 lbs.
Power Options:
• Electric, standard
• Pneumatic
• Hydraulic

1. Stand
2. Protective Cage
3. Counter Weight
4. Wire Rope
5. Swivel
6. Carabiner
7. McKissick M-491 Tower Block
8. Crosby G-2130 Bolt Type Shackles
9. Weld on lug
10. Class I, Div. II controls enclosure
11. Class I, Div. II controls receiver enclosure
12. Class I, Div. II electric motor
13. Blocstop®
14. Antenna

* Class I, Div. II Wireless Remote Control same as for MaxiRider™ I

Houston, TX
713-674-2266

Beaumont, TX
409-729-9187

New Iberia, LA
337-369-3903

New Orleans, LA
504-496-0196

Panama City, FL
850-769-1120

Odessa, TX
432-332-5922

Oklahoma City, OK
405-789-2800

Rock Springs, WY
307-382-6622